

FC/FE VACUUM SWITCHES



FC



PRESSURE CAPSULE DETAILS

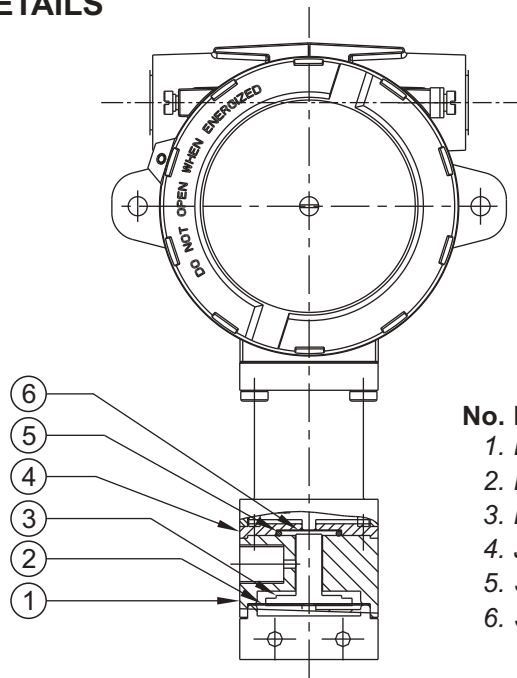

No. Description

1. Disc
2. Diaphragm
3. Plunger (SS316)
4. Junction Plate
5. Sealing O-Ring (Teflon®)
6. Sealing diaphragms (Teflon®)

Note : *wetted parts* are mentioned in italics.

INSTALLATION DRAWING

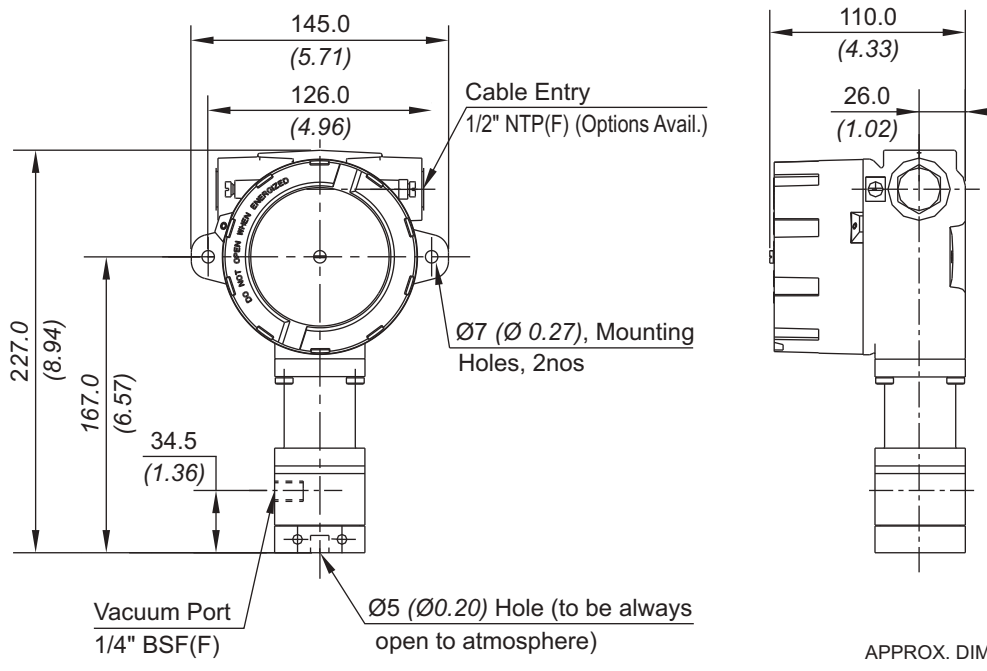

APPROX. DIMENSIONS IN $\frac{\text{mm}}{\text{inches}}$



FE



PRESSURE CAPSULE DETAILS

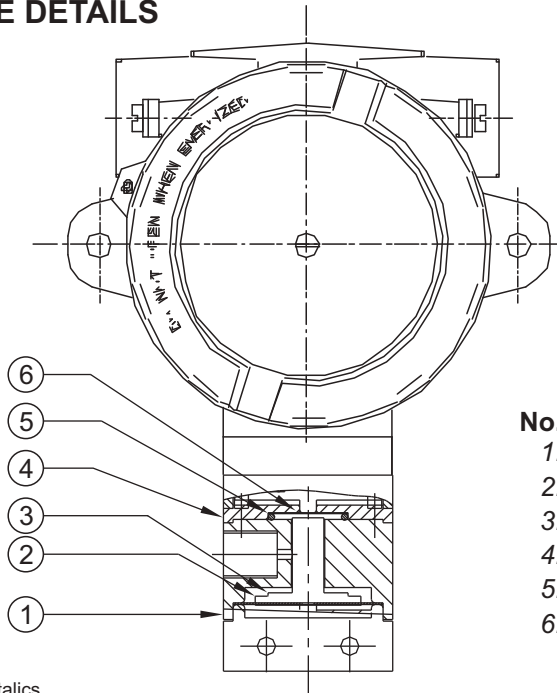

No. Description

- 1. Disc
- 2. Diaphragm
- 3. Plunger (SS316)
- 4. Junction Plate
- 5. Sealing O-Ring (Teflon®)
- 6. Sealing diaphragms (Teflon®)

Note : *wetted parts* are mentioned in italics.

INSTALLATION DRAWING

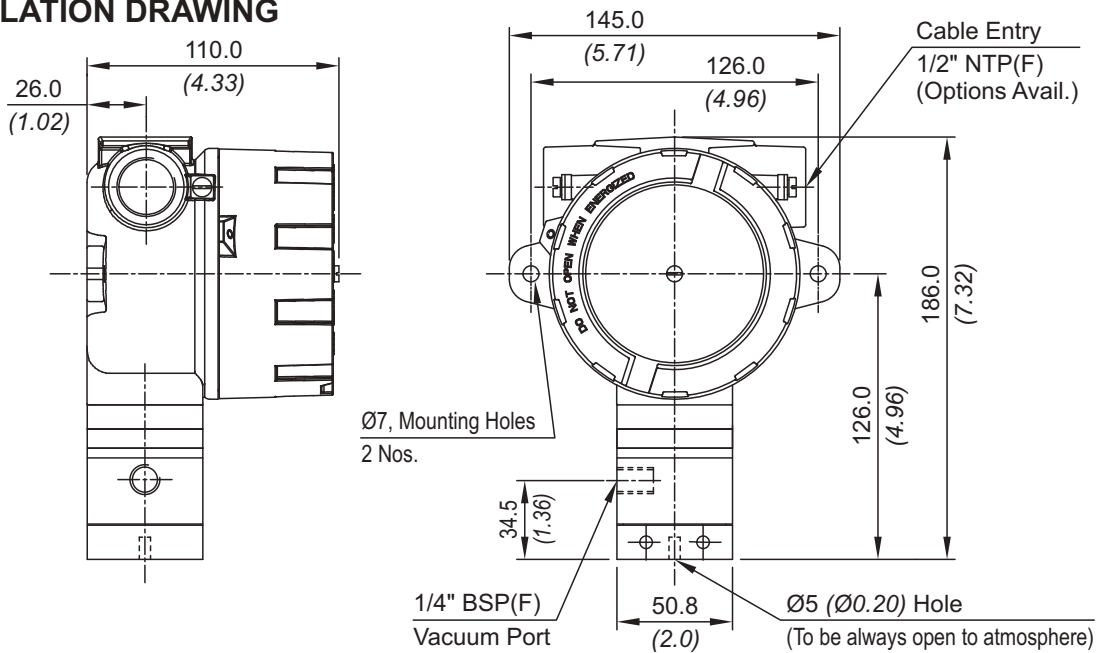

APPROX. DIMENSIONS IN $\frac{\text{mm}}{\text{inches}}$

FC/FE VACUUM SWITCHES

RANGE SELECTION TABLE

| Range Code | Range mm Hg ("Hg) | Differential* mm Hg ("Hg) | Maximum Working Pressure bar (psi) |
|------------|-------------------------------|---|--|
| | | Approximate Maximum for "A1" microswitch | |
| V00 | † 760 - 100 (29.92 - 3.94) | 10 (0.39) | 12 (174.05) |

*Minimum differential increases with set point (Graphs available on request)

† Typical values achieved at sea level, total vacuum that can be achieved varies mainly with altitude.

*Please indicate specifically the differential value in enquiry/order, when it is critical in your application.

HOW TO ORDER FLAMEPROOF VACUUM RANGE SWITCHES

| Group 1 | Group 2 | Group 3 | Group 4 | Group 5 | Group 6 | Group 7 | Group 8 |
|---|--|--|---|-----------------------------|--|---|---|
| Non standard allocation | Gas Group Classification | Cable Entry Size | Switch Type | Range Code (values in mmHg) | Microswitch Type | Pressure Port Material / Size | Diaphragm |
| <input type="checkbox"/> Reserved for non-standard options not covered in catalogue. Will be given by manufacturer, only after agreement of supply details with customer. | FC = Flameproof pressure switch, ATEX & IECEx approved, with Aluminium head as per IS/IEC 60079-1 for Gas Gr. IIC FE = IP66 Flameproof pressure switch, KLPL approved | 1 = Al. head 1/2" NPT threads 2 = Al. head 3/4" NPT threads 3 = Al. head M20 x 1.5 threads 4 = Grey CI head 1/2" NPT threads 5 = Grey CI head 3/4" NPT threads 6 = Grey CI head M20 x 1.5 threads 7 = SS head 1/2" NPT threads 8 = SS head 3/4" NPT threads 9 = SS head M20 x 1.5 threads | V1 = vacuum switch, fixed differential without scale | V00 = († 760 - 100) | A1 = General purpose microswitch rated at 15 A; 250 VAC A2 = Hermetically sealed for corrosive environments A3 = gold plated contacts for low voltage applications A4 = DPDT configuration A5 = for high DC ratings A6 = elements with adjustable deadband A7 = 2SPDT switching elements A9 = General purpose microswitch rated at 5 A; 250 VAC | S1 = SS316 / 1/4" BSP(F) S2 = SS316 / 1/4" NPT(F) | 0 = Neoprene 1 = Teflon |
| | | | | | | Please refer Page No. 68 for Pressure Port options | For additional wetted parts please contact Sales Office |
| | | | | | | Please refer Page No. 69 for Microswitch options * Please refer note under Range Selection Table | |

eg. A flameproof switch for gas group IIC, with 1/2" NPT cable entry in aluminium housing as 1SPDT vacuum switch, having 760 mm Hg to 100 mm Hg vacuum range, with 15Amp. microswitch, SS316 pressure housing with 1/4" BSP port size & neoprene diaphragm shall be specified by

| Group 1 | Group 2 | Group 3 | Group 4 | Group 5 | Group 6 | Group 7 | Group 8 |
|--------------------------|---------|---------|---------|---------|---------|---------|---------|
| <input type="checkbox"/> | FC | 1 | V1 | V00 | A1 | S1 | 0 |

Please specify full model number to avoid ambiguity. If only the first two groups are specified while ordering, uncalibrated switches with standard wetted parts and enclosures will be supplied.